

GC Alternate Scope:
 Replace existing recessed lights with new LED fixtures per the plans.
 Remove the track lighting and replace with new LED fixtures per the plans.
 Extend existing areas of GYP ceiling as noted on plan
 Provide best option for the hallway ceiling rework

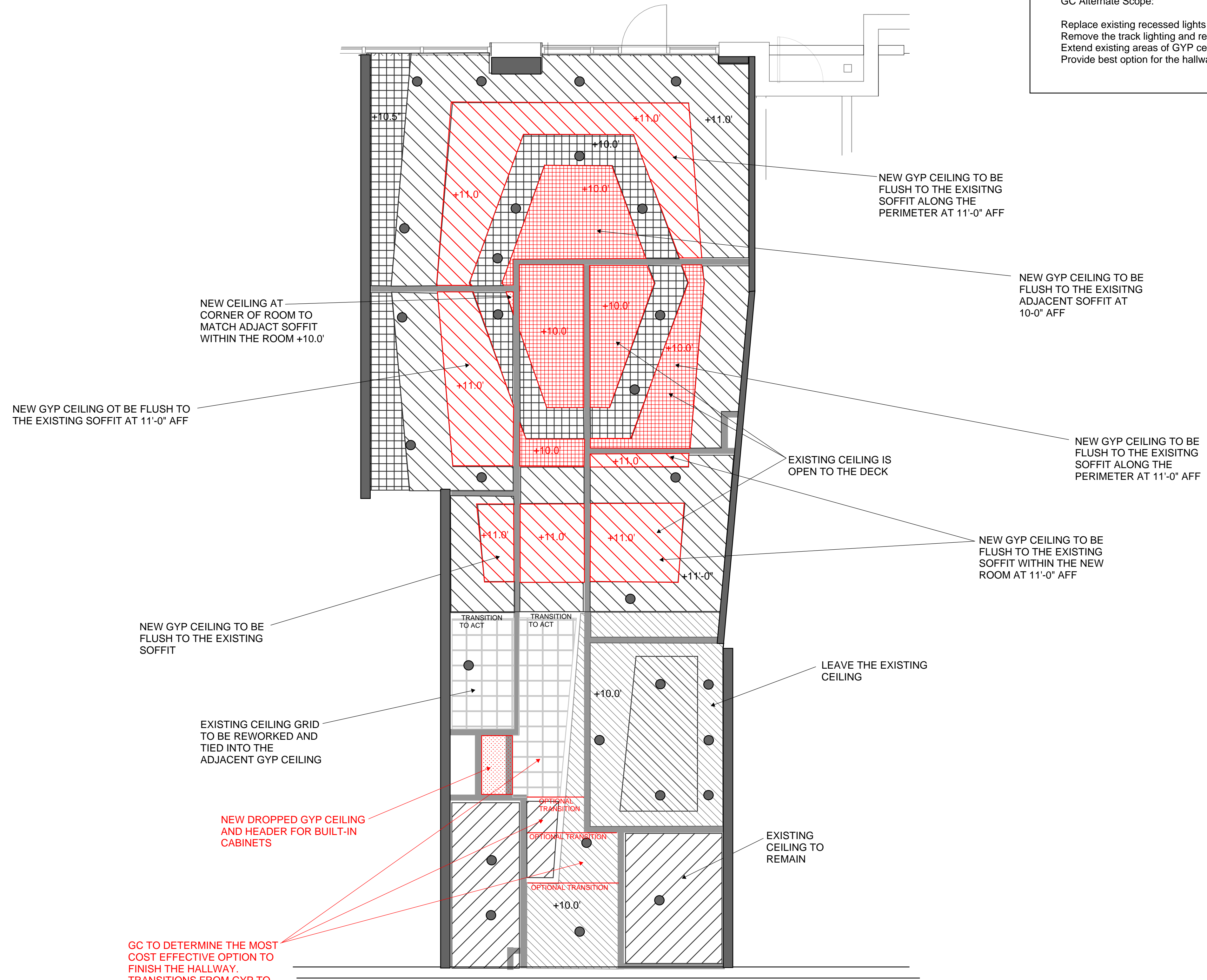

GC TO DETERMINE THE MOST COST EFFECTIVE OPTION TO FINISH THE HALLWAY. TRANSITIONS FROM GYP TO DROP CEILING MUST BE PERPENDICULAR ACROSS THE HALLWAY, WITH 90 DEGREE CORNERS ONLY.

2 REFLECTED CEILING PLAN
 SCALE: 1/4" = 1'-0"

BIDDING QUESTIONS CONTACT 920-757-1486

LOOK LAB
 4164 EAST 8TH PL
 DENVER, CO 80220-3955

CHECKED BY:	Staff
DRAWN BY:	Staff
DATE:	
SCALE:	PER PLAN
PROJECT No.:	
SHEET TITLE	BID ALTERNATE 12
SHEET No.	